

triton Jigsaw Kit

AJA 300

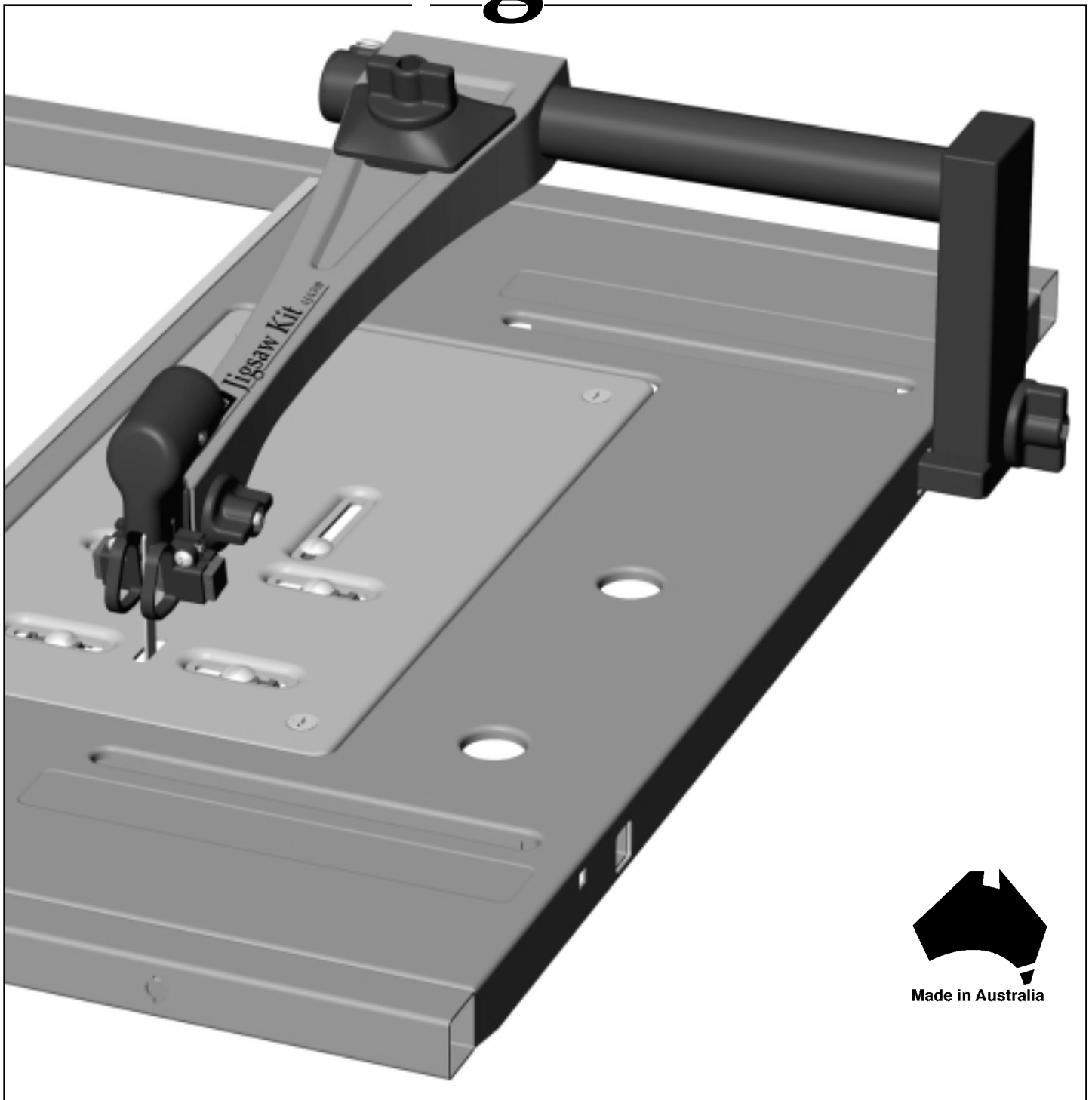

Assembly & Operating Instructions

Thank you for purchasing the Triton Jigsaw Kit - AJA300 for use on your Router Table - RTA300. You now have a very versatile accessory which makes cutting with your jigsaw a safe, easy and accurate operation.

This product suits the Triton Router Table - RTA 300 only, mounted to either a Triton Workcentre or a Triton Router Stand.

Tools required: Philips-head screwdriver, 10mm spanner, Square.

COMPONENTS LIST

- ① Jigsaw Plate x 1
- ② Overhead Arm x 1
- ③ Support Arm x 1

Bag 1 - Jigsaw Plate Fasteners

- ④ Plate Clamp Base x 4
- ⑤ M6 x 45 Countersunk Screw x 4
- ⑥ M6 Flange Nut x 9
- ⑦ Plate Clamp Knob (flat bottom) x 4
- ⑧ Back Stop x 1
- ⑨ M6 x 20 Coach Bolt x 1
- ⑩ Clamp Base x 4
- ⑪ M6 x 40 Coach Bolt x 4
- ⑫ Clamp Knob (recessed bottom) x 4

Bag 2 - Support Arm Fasteners

- ⑬ Blade Guard x 1
- ⑭ M6 x 40 Coach Bolt x 2
- ⑮ Small Round Knob with M6 nut x 1
- ⑰ Bridge x 1
- ⑱ M6 x 55 Hex Bolt x 1
- ⑲ Arm Locator x 1
- ⑳ M6 x 10 Screw x 1
- ㉑ M6 Flange Nut x 1
- ㉒ Tube Plug x 1
- ㉓ Large Round Knob with M6 nut x 2

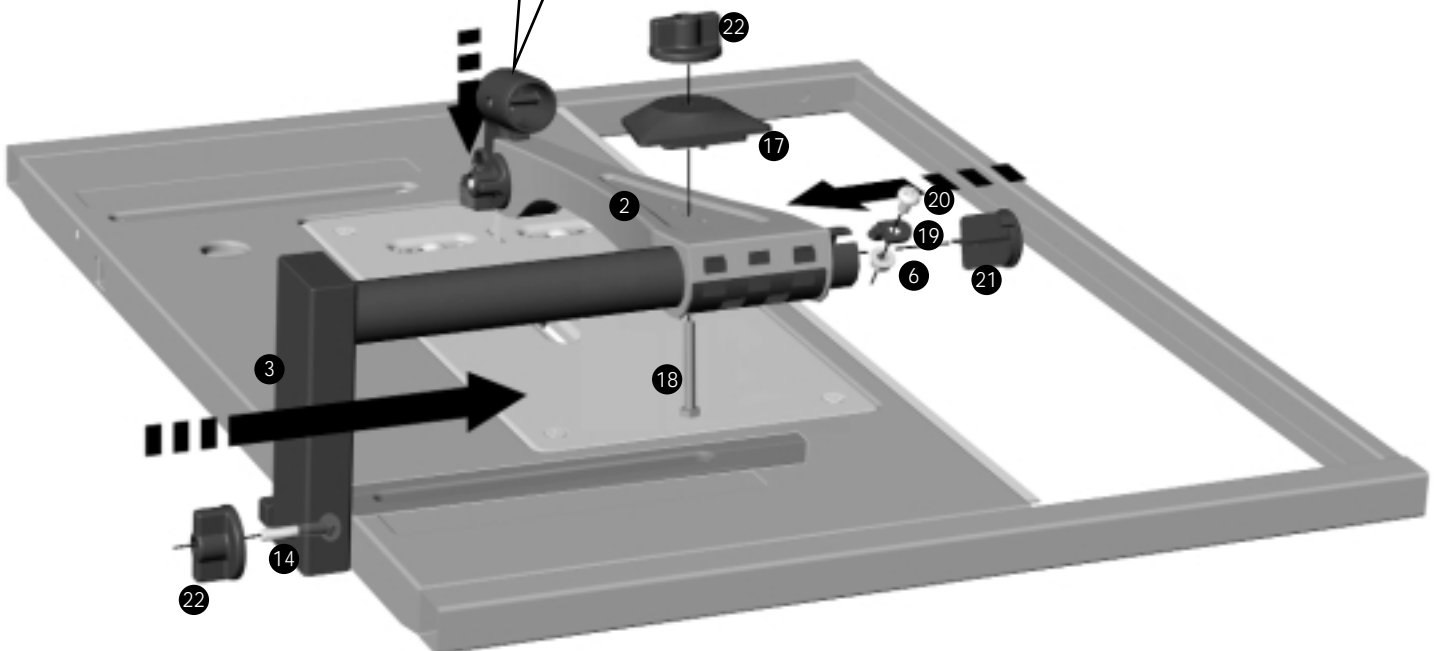
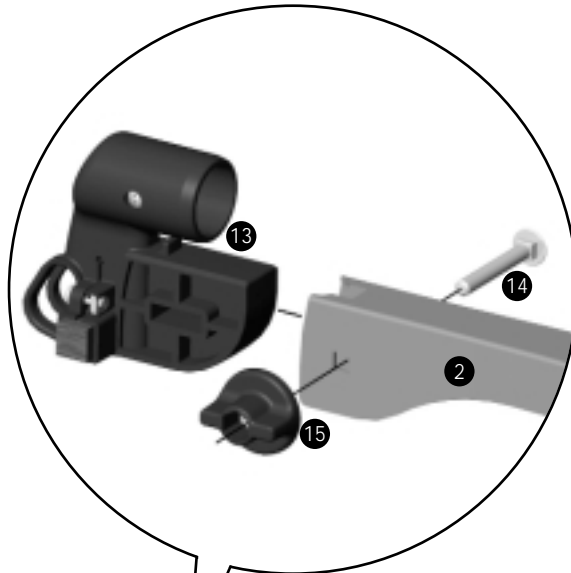
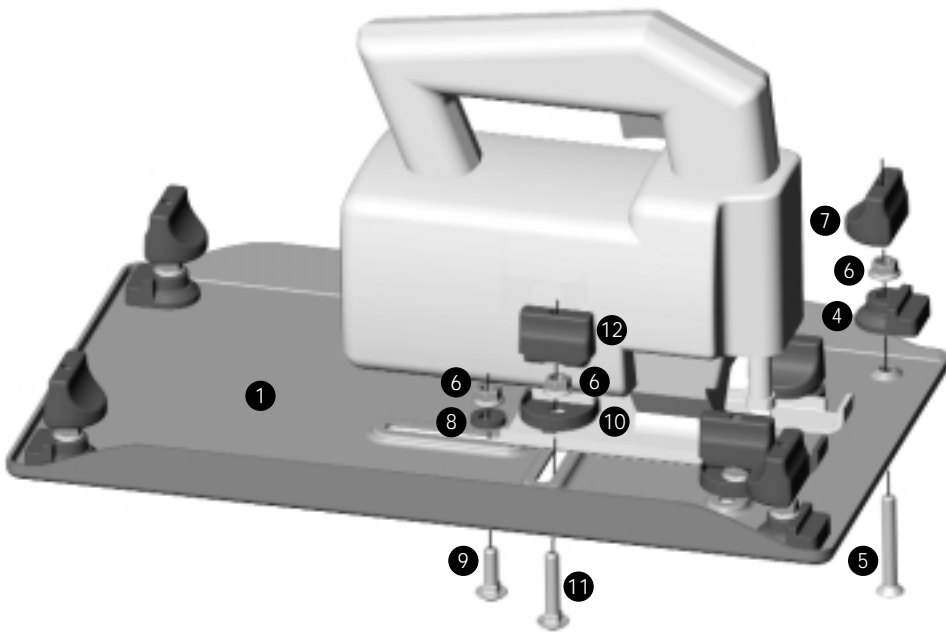

ASSEMBLY

Step 1 - Fit the Plate Clamp Bases (4) to the corners of the underside of the Jigsaw Plate (1) with the M6 x 45 Countersunk Screws (5) and M6 Flange Nuts (6), as shown. Do not yet tighten.

Fit the jigsaw plate into the router table cut-out (clamp bases facing down) with the slots at the front (switchbox end). Push the clamp bases outward until they locate against the square tube supports while tightening with a Philips-head screwdriver.

Screw the Plate Clamp Knobs (7) onto the screws until they hold the plate firmly into the table (they cut their own thread).

In use: The clamps have flat side edges. When all four cut-aways are facing outward the plate can be removed. Turn the knobs clockwise about half a turn to tighten it back down.

Step 2 - For this step release the plate clamp knobs and turn the plate upside down in the router table cut-out, with the clamps upward.

Use a square to ensure the jigsaw blade is set at 90° to its base, and make any necessary adjustments.

Place your jigsaw onto the plate with the blade locating approximately central through the jigsaw blade slot. Position the jigsaw base approximately parallel to the sides of the plate.

Fit the Back Stop (8) to the rear slot using the M6 x 20mm Coach Bolt (9) and a flange nut, as shown. Tighten into position against the back edge of the jigsaw base.

Position the four Clamp Bases (10) into the slots on either side of the jigsaw base with their straight edges touching the sides of the base. Tighten them into position with the M6 x 40mm Coach Bolts (11) and M6 flange nuts, as shown.

Screw the Clamp Knobs (12) on (they cut their own thread) until they tighten firmly onto the top edge of the jigsaw base. The flat sides of the clamps should be facing away from the jigsaw. **Note:** It may be necessary to remove the jigsaw while screwing the clamp knobs into position.

In use: When the flat sides of all four clamps are facing inward the jigsaw can be removed. Turn the knobs clockwise half a turn to tighten it back down.

Remove the plate then re-fit and lock it into the Router Table with the blade pointing upward.

Step 3 - Push the Blade Guard (13) into the front of the Overhead Arm (2) and fit the M6 x 40mm Coach Bolt (14) and Small Round Knob (15), as shown. As the bolt is designed for a firm fit pulling the guard forward slightly will allow easier assembly.

Step 4 - Insert the M6 x 40mm Coach Bolt (14) from inside the edge of the Router Table. Fit the Support Arm (3) into the square hole and onto the coach bolt and slide it fully home, as shown.

Tighten into position with a Large Round Knob (22).

Slide the overhead arm onto the round tube of the support arm.

Raise the arm and fit the Bridge (17) using the Hex Bolt (18) and Large Round Knob (22), as shown.

Lower the the arm onto the jigsaw blade and position the arm until the blade is central within the guard. Tighten the arm in place. **Storage note:** Loosen the arm clamp when storing for extended periods to avoid fatigue.

Step 5 - Insert the Arm Locator (19) into the slot on the support arm round tube, with the side wall of the overhead arm engaging in the groove on the locator. Tighten the locator firmly in position using the M6 x 10mm Screw (20) and Flange Nut (6), as shown.

Push-fit the Tube Plug (21) into the end of the tube, as shown. Note the notch in the plug must line up with the arm locator.

Loosen the round knob on the blade guard and adjust the guard forward or backward until the teeth on the jigsaw blade are just in front of the two wooden guide blocks, then tighten. Loosen the two Philips-head screws in the blade guard and move the guide blocks in until they almost touch the sides of the blade, then tighten. See Fig. 2.

In use: When the guide blocks wear down, over time, they should be re-adjusted close to the blade. Blocks can be reversed and rotated until all sides are worn. Replacement blocks can be ordered through your local Triton stockist, or alternatively you can make your own from any fine grained hardwood.

Dust Extraction

The Jigsaw Kit has been designed for use with any vacuum cleaner for sawdust extraction. While the stroke of the jigsaw forces most dust beneath the table, connecting to a vacuum source provides better visibility of the cut line and reduces airborne dust.

Screw the vacuum hose, supplied with your Router Table, onto the dust port in the back of the blade guard (left-hand thread) and plug the wand of your vacuum cleaner into the hose adaptor. For a larger collection capacity, consider fitting a Triton Dust Collector (DCA300) to your vacuum.

RECOMMENDATIONS FOR JIGSAW SELECTION

Better jigsaws have the following features:

- Large cutting capacity in timber (50mm or more).
- Variable cutting speeds (useful for cutting different materials).
- A roller guide at the back of the blade which provides support when cutting, ensuring less sideways deflection of the blade.
- A tilting baseplate for bevel cutting when handheld.
- Some top-of-the-line models have a pendulum or elliptical cutting motion to speed up the cutting of thicker materials. This feature cannot be used with the Jigsaw Kit, and must be switched off.

SAFETY & OPERATION

- Always disconnect your jigsaw from power when making any tool adjustments.
- Always wear eye protection whenever operating power tools. The use of a dust mask and ear muffs is also recommended.
- Do not wear loose clothing or jewellery when operating power tools. Tie back long hair.
- If the power switch on your jigsaw does not permanently lock on, use tape or a releasable cable tie to hold the switch on during operation. Alternatively a trigger strap (part no. AGA001) can be ordered through your local Triton stockist.
- Always adjust the overhead arm to suit the thickness of your workpiece. Loosen the arm clamp and set the height of the arm until it rests on top of your workpiece, then tighten (Fig. 1).

Fig. 1

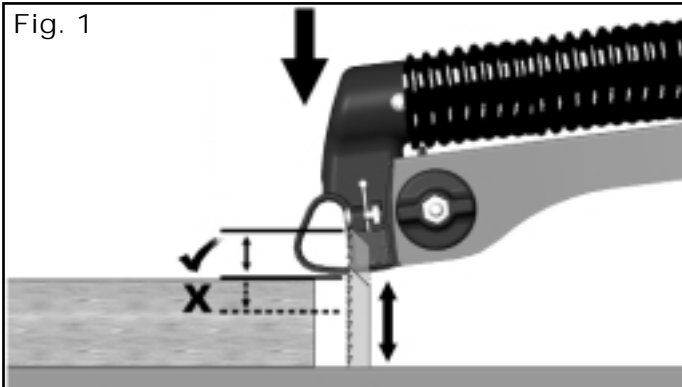

- Do not over-tighten the arm clamp. This will allow the arm to raise should the blade contact it during use - rather than breaking your blade.
- Before turning on the jigsaw check that the blade extends beyond the thickness of your workpiece at the bottom of its stroke. At least one blade tooth should always project above the work (Fig. 1) and the blade should never exit the guide blocks. Failing to ensure this can damage your blade, or cause the overhead arm to “fling” up.

Fig. 2

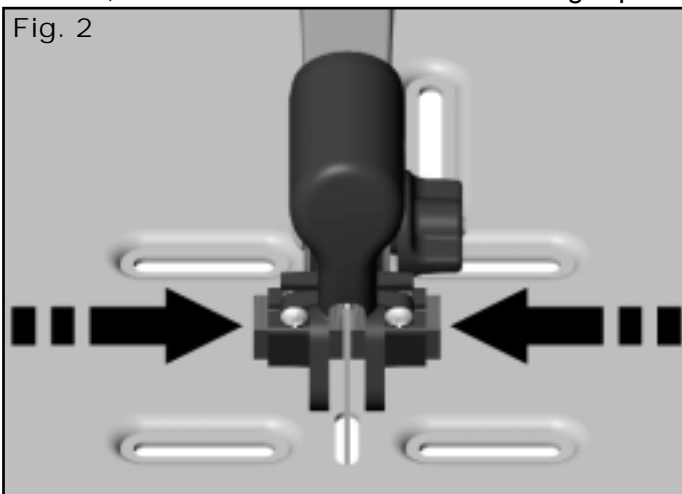

- Regularly check that the blade is located centrally inside the guard with the guide blocks close to the blade but back from the blade teeth (Fig. 2).
- Always keep fingers well clear of the blade and never trail your fingers behind the cut line.
- The overhead arm should be fitted and correctly adjusted at all times.
- Never start the jigsaw with the blade touching the workpiece.
- Remove all loose objects from the table before operating to prevent them from vibrating into the cutter.
- Feed the workpiece slowly, particularly when cutting along the grain, or when using fine toothed blades (Fig. 3). Smoking or burn marks on the cut edges indicate the curves were too tight, or the feed rate was too fast. Overheating can dull a blade rapidly.

Fig. 3

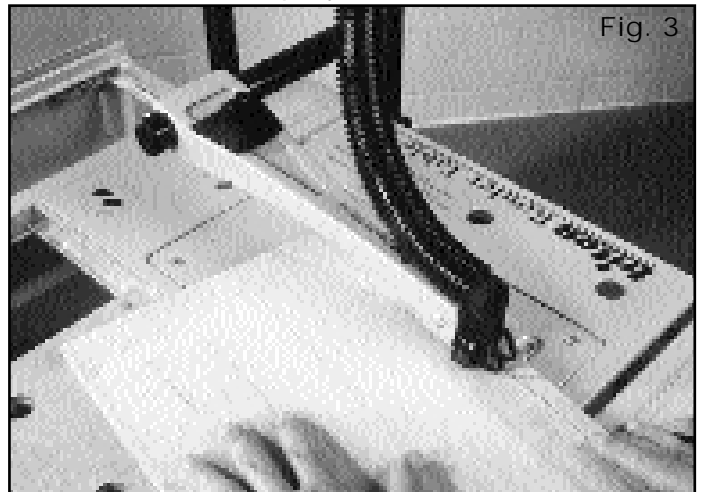

- Hold the workpiece firmly and evenly against the table while guiding it smoothly through the blade.
- If you wish to stop mid-way through a cut, switch off the power with your knee and hold the workpiece steady until the blade has completely stopped.
- Don't try to cut too tight a radius in thick material. If necessary, edge up to the line in a series of shallow cuts, whittling away the waste.
- There is a wide selection of jigsaw blades available, and using the right blade for the material being cut will ensure best results. For cutting small circles and sharp curves we suggest you fit a narrow blade.
- Ensure all fasteners are regularly checked for tightness as jigsaw vibration can loosen them.
- Always disconnect power when work is completed for the day, or when leaving the unit unattended.

Due to our company policy of continuous product improvement, specifications may change without prior notice.

Made in Australia by: Triton Manufacturing & Design Co. Pty. Ltd. ACN 000 195 951 ABN 43 000 195 951
 14-18 Mills St, Cheltenham, Vic. 3192 Ph: (03) 9584 6977 Fax: (03) 9584 5510
 E-mail: tools@triton.net.au Web Site: http://triton.net.au

International Offices:

Canada - Toll Free: 1 888 874 8661
 Japan - Free Call: 0120 171 079
 New Zealand - Ph: (09) 415 2545

South Africa - Free Call: 0800 600 432
 United Kingdom - Free Call: 0800 856 7600
 USA - Toll Free: 1 888 874 8661